

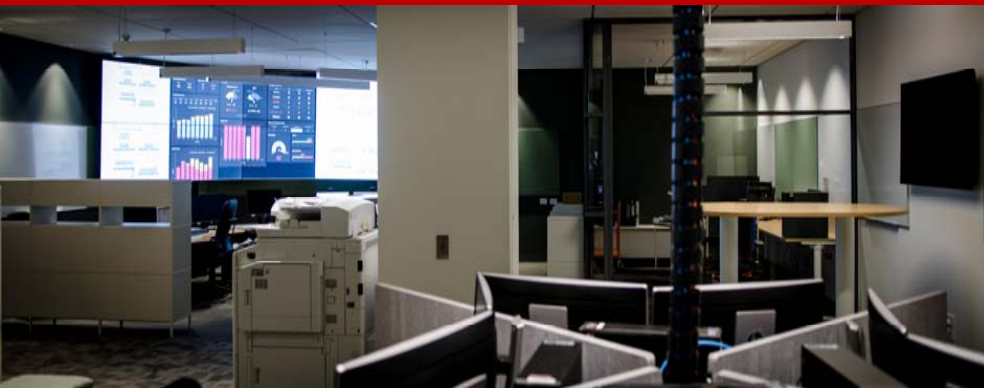

Liverpool hospital set up the centralised Hospital Flow Control Centre to manage and monitor its bed base, coordinate patient movements, allocate beds, and monitor numerous activities, flows and utilisations throughout the hospital.

The critical outcome was integration of separated but crucially connected services in one integrated control room, with seamless flow critical for patient access and overall patient experience.

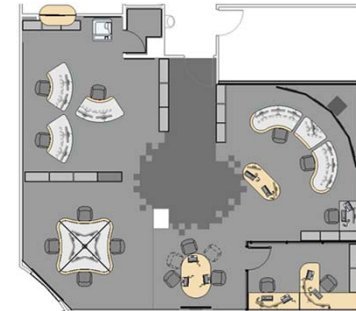

The ergonomic design of the Liverpool Hospital Flow Control Centre...

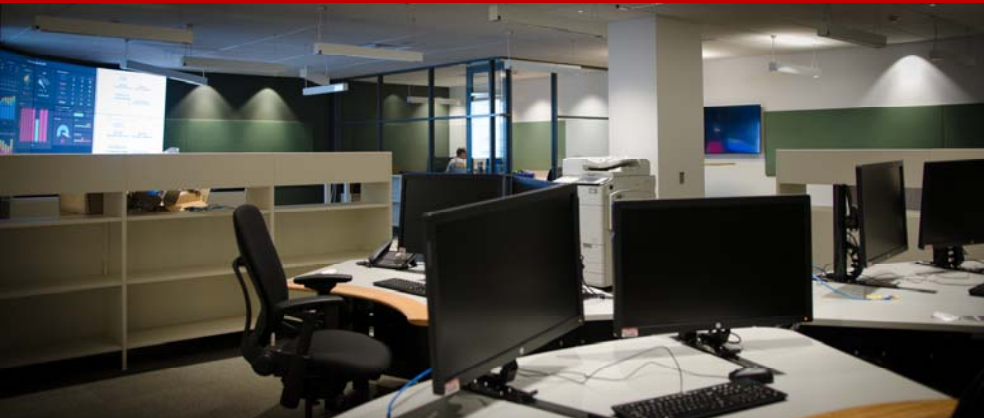

“The CCA team worked collaboratively with us to understand our key players and stakeholders and how we communicated with them across the Hospital to support patient access.

Our state of the art Control Centre utilises technology and concepts that were unheard of to Health and took our ability to communicate „ and oversee our performance to the next level.

*Amy Coghill, Business Manager – Non-Admitted Patients & Partnerships
South Western Sydney Local Health District, Health NSW*